

80' QUICK DEPLOY TOWER



World class mobile towers
with flexible leasing options.

Tower:

Double-Bolted Joints
Hot Dip Galvanized Steel
12.5" Tower Width
5/16" Thickness ZigZag Bar Design
ANSI/TIA/EIA-222-F-1996 Compliant

Equipment Bracket

Maximum Load 500 lbs. Guyed
80 MPH Wind (3-sec. gusts)
Includes: (1) Base Plate, (2) Stabilizer
Triangles, and (1) Top Plate

24/6 Tower Support:

972-721-0150

www.solaristechservices.com

QUICK DEPLOY 80' TOWER

+1.972.721.0150

SUPPORT@SOLARISTECHSERVICES.COM

Difficult Terrain & Remote Locations:

lightweight solution for providing extended coverage in difficult terrain, remote locations, new constructions, security needs, etc.

Short or Long Term Needs: easily movable yet set in a solid, in-ground foundation provides rapid deployment for temporary or permanent coverage.

Tower Base Construction

- Durable, lattice design
- Aluminum or Galvanized Steel options
- 48" anchor depth for stability in high winds
- Ability to withstand wind speeds of 80 mph
- Weight 130lb
- Easily erected without the use of machines, electricity, or winches
- Easily transportable. Up to 40 towers can be transported on a single tractor-trailer

Tower Set-Up:

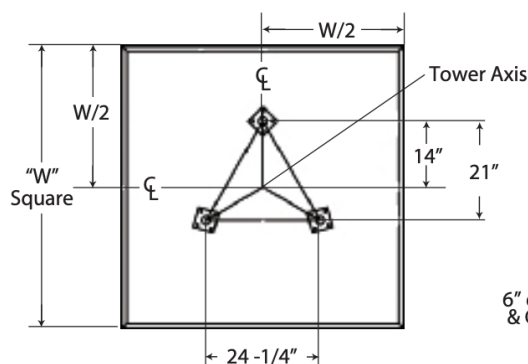

See tower elevation page for "W" dimension.

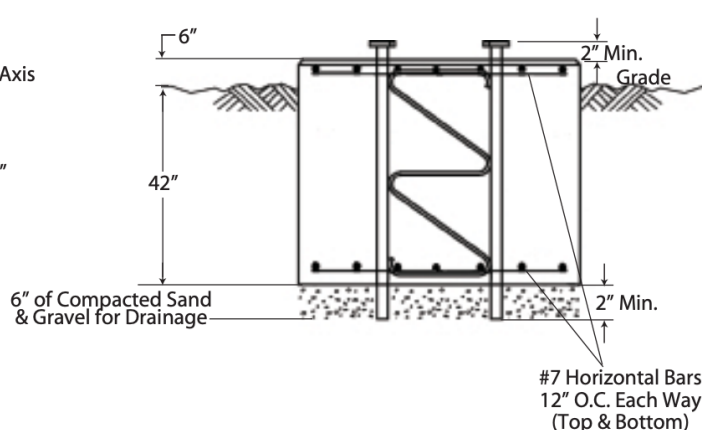

WHAT PEOPLE ARE SAYING ABOUT SOLARIS

"Solaris has been great to work with all the way through the purchasing of our C.O.W. From the inquiry process to ordering and finally through to delivery & training. They helped us in every step and were available for support whenever we needed them."

- Rick K.



**SOLARIS
TECHNOLOGIES
SERVICES**